

Kadey-Krogen 55 Olympia



JMYS

3010 Old Ranch Parkway, Suite 440, Seal Beach, CA 90740
+1 949.355.4950 | www.JMYS.com

Jeff Merrill Yacht Sales, Inc. | 3321 SE 14 Avenue | Fort Lauderdale, FL 33316



Olympia

Asking: \$1,595,000.00

Location: Stuart, FL

Jeff Merrill Yacht Sales, Inc. © 2020 All Rights Reserved www.JMYS.com

Kadey-Krogen 55 Olympia

Olympia is a 2014 Kadey-Krogen 55 Expedition yacht. She is offered for sale by her original owner who has meticulously maintained her. **Olympia's** spacious interior, storage and ease of boarding/disembarking make her an excellent live aboard, full-time cruising vessel. In addition to the port and starboard boarding doors at cockpit sole level, **Olympia** has two port and starboard access points on the bow and two more port and starboard access points on the Portuguese bridge. The walk-in, full height engine room has three accesses: primarily through a full-size door in the guest head, through two hatches in the saloon sole and down a short flight of steps through the lazarette. Her owner has cruised her extensively from the Bahamas (including Eleuthera and the Exumas) to Maine.

She is ready to take you cruising coastal waters or crossing the ocean to explore new ports of call abroad.

Olympia is an excellent vessel for the active owner operator couple. Her generous size offers spacious quarters for full time live aboard, entertaining and hosting guests. Guests will appreciate the private accommodations with separate head.

Her all cherry interior layout features two staterooms: a forward, full beam master with ensuite full head and a spacious guest room with twin beds. Another full head is a step across the companionway from the guest stateroom. The walk-in engine room has stand up head room for easier service and inspections with central access to both engines. The large, upper level pilothouse has 360-degree visibility and is equipped with two Llebrog helm chairs and a refrigerator/freezer. The spacious entry level saloon is wrapped in warm cherry and features two custom leather club chairs, an L-shaped settee covered in Ultraleather, a bookcase, a cherry hi-lo table that opens to easily seat eight for dinner and can be moved outside for al fresco dining, a 57-bottle wine refrigerator and copious storage. The large, L-shaped gourmet galley is ideal for preparing meals for two or for a crowd. The galley is equipped with top of the line, full size appliances, including a Jenn Air refrigerator with French doors (including an ice maker), GE Profile microwave/convection oven, Blue Star four burner propane range, GE Profile dishwasher, granite countertops, double rolling trash containers, and a large stainless steel sink.

DESCRIPTION:

Cockpit: The cockpit provides a very spacious, covered outdoor space for relaxing with friends, a cocktail or enjoying a meal. Enter the cockpit from the aft swim platform (fitted with three staples for ease of boarding a tender or returning from a snorkel trip) or comfortably from the dock through the port or starboard boarding door. You have hatch access down a short ladder to the lazarette below. There are two 50-amp shore power connections powered by a Glendinning retraction system. A hot and cold freshwater cockpit shower is built into the transom. A fresh water washdown inlet makes deck cleaning a pleasure. Two fuel fills for the port forward and aft tanks are located in the cockpit to port and two fuel fills for the starboard forward and aft tanks are located in cockpit to starboard. The boat deck may be accessed from a ladder through a sliding hatch on the port side of the cockpit. Access to the interior is through her weather-tight, painted aluminum Diamond SeaGlaze double saloon door. An accordion-pleated, tinted screen allows soft breezes to flow through the boat without the inconvenience of insects.

Kadey-Krogen 55 Olympia

Saloon: The full beam, airy, high ceiling saloon is surrounded by five generous sized, opening Diamond SeaGlaze windows (with screens) covered with built-in custom cherry wood blinds set under cherry valances. There is a comfortable Ultraleather-covered L-shaped settee (with generous storage underneath) to port and two custom leather club chairs to starboard, perfectly positioned to view the 46" flat screen Smart TV. The TV can be raised and lowered by the Aritex lift into the cabinet behind the settee when not in use. A movable high-low cherry table sits in front of the settee, ready to serve an intimate meal for two or can be opened to entertain dinner guests. The table is easily moved into the cockpit to enjoy al fresco dining. *Olympia's* spacious interior is bright and contemporary with satin finished teak and spruce floors. A bookcase on the aft starboard bulkhead provides two shelves for displaying books. A granite countertop (lit from below) houses a cabinet with a built in Garmin VHF radio and several small shelves for storage. A 57-bottle wine refrigerator with controls for both red and white wines is within easy reach. To starboard, two cabinets with sliding doors behind the club chairs provide ample storage. An outstanding feature of this late model Expedition, and the first of this design layout, is the curving cherry staircase to the pilothouse. The treaded steps have household sized risers and a gorgeous solid handrail that allows visualization of part of the pilothouse through the saloon as well as exceptional safety and stability while underway. A huge cabinet under the steps provides storage for large items. Two wall sconces enhance the lighting provided by numerous LED lights mounted into the soft, covered headliner.

Galley: The exceptionally large L-shaped galley was designed with the gourmet cook fond of entertaining in mind. All of the essentials including a deep basin stainless steel sink and Jenn Air French door refrigerator/freezer with icemaker wait to assist you. There are overhead cabinets and large drawers, all with ample space for glasses, plates, cups, utensils and silverware. A custom spice cabinet organizes your spices within easy reach and a bookshelf holds important cookbooks. For preparing meals, there is a large, GE Profile microwave/convection oven and a Blue Star four-burner propane range and oven. A GE Profile dishwasher makes clean up a breeze. There is additional storage to port for pots, pans and other galley equipment, all within easy reach on rollout top and bottom shelves. The galley is further enhanced with a lit "curio" cabinet that will show off your treasures on a glass shelf. A good-sized cabinet below will come in handy for bottles, cans and other galley essentials. Two other cabinets to starboard will hold other supplies. The top cabinet is vented to accommodate a Blu-Ray disc player, Direct TV receiver and other electronic entertainment devices.

Pilothouse: The raised second level, comfortable pilothouse covered in cherry with a high ceiling offers excellent all-around visibility from the two, multi-positional Llebroc Ultraleather helm chairs. Custom built in cherry wood blinds provide light regulation and privacy. An Ultraleather settee pulls out to become a full- size berth. Ample storage exists under the settee for chart books and other assorted equipment. A large cherry covered refrigerator with small freezer not only provides nice counter space but also eliminates the need to go below for a cool drink or snack when underway. In addition to the twin throttles, there is an impressive assortment of user-friendly Garmin navigation/communication electronics with controls for the bow thruster, engines, and stabilizers, all within arm's reach. The helm station safely provides monitoring of the boat's systems and convenient access to the autopilot, either manually or with the handheld, wireless remote. Breaker switches for the Maxwell windlass, engine controls, Kahlenberg horn, Ritchie compass, windshield wipers, navigation lights and monitors are installed behind a tinted glass door in an easily accessed panel to starboard with clearly labeled

Kadey-Krogen 55 Olympia

breakers. **Olympia** is equipped with AIS that both transmits and receives. The floors are covered with a foam green carpet (2017) for comfort. Two painted aluminum Dutch doors on either side open outboard to allow access to the boat deck, Portuguese bridge and bow. A large stainless steel, destroyer style wheel provides maximum safety for steering. Temperature is controlled via a dedicated air-conditioning system for the pilothouse (12,000 BTUs). In settled weather, the Dutch doors and four large screened windows can be opened for fresh air. Port and starboard chart lights provide perfect lighting for night reading of charts while LED lights mounted into the soft headliner provide adequate light for reading or boat chores. Two large drawers and cabinets on either side of the helm will accommodate all your navigation equipment, including charts, books, binoculars, remotes and laptops when not in use.

Master Stateroom: The comfortable master stateroom features an island queen with Tempur-Pedic mattress, four large drawers and deep storage under the bed, which can be easily raised on its two gas struts. Two hanging lockers – one to port, the other to starboard and two drawers to starboard with a cabinet below provide storage in addition to a dresser with mirror and lights above. There are small cabinets surrounding the bed with ample storage. Two wall sconces on either side of the bed provide subtle lighting. Large Ocean Air hatches above the bed provide refreshing breezes at anchor. Each hatch has a screen that pulls from one side. If darkness is what you want, a shade cover that matches the headliner pulls out from the other side. On deck, custom hatch covers that are locked in place protect the tinted hatch lenses. An ensuite head completes the comfort of the master stateroom. A Dometic MasterFlush fresh water electric toilet eliminates the need for a foot pedal. The Corian sink is surrounded by a granite countertop, with a cherry cabinet underneath. An overhead mirror with three lights above is framed in cherry. The large shower is enclosed with a bi-fold door, has a seat and a well-pressurized hand-held showerhead with several options for shower intensity. Overhead LED lights provide excellent lighting throughout the master stateroom and head.

Guest stateroom and head: The large guest stateroom to starboard amidships consists of two twin beds, both covered in Sunbrella fabric. There is a hanging locker to starboard with a large overhead cabinet and a desk with pencil drawer, two supply drawers and a file drawer. Ample storage is provided - beneath the beds, in a bank of five drawers under each bed and in a cabinet set between the beds. A full-size and separate Bosch clothes washer and clothes dryer hide behind a set of louvered double doors. The large and airy guest head is a step across the companionway to port. It boasts a full shower with seat, well-pressurized handheld shower with several options for shower intensity and a bi-fold door. A large cabinet over the Dometic MasterFlush fresh water electric toilet, a mirrored, double door, lit cabinet over the Corian sink and granite countertop with several cabinets below provide household-type storage. Well placed, non-opening port lights provide natural light.

Engine Room: The six-compartment engine room can be entered by descending the steps behind the watertight door in the guest head, through a double hatch in the saloon sole or through the lazarette. The twin Tier 3 John Deere engines are housed in their own watertight engine space, mounted on either side of the centerline, making maintenance an easy task. The aft port section of this space houses a Northern Lights 16 kW generator. The generator (with Sound Shield) is easily accessed from both its front and back. There are four aluminum fuel tanks, two forward and aft to port and two forward and aft to starboard. The port fuel tank is plumbed to the generator and all four tanks are plumbed to the ESI fuel polisher/transfer system with supply and return. Two 250-gallon stainless steel water tanks are

Kadey-Krogen 55 Olympia

located to port and starboard in the third engine room compartment. The engine room is protected by a Seafire fire suppression system. Newly installed Lifeline AGM batteries are divided into three banks: 16 house (June, 2018), 4 engine start (February 2019), and 1 generator start (October, 2018). The 16 house batteries are housed in their own watertight compartment. A Magnum inverter/charger offers faster charging of the batteries. At the base of the steps resides a 30-gallon Torrid water heater that provides a seemingly endless supply of hot water. A workbench with sink simplifies engine room chores. The stabilizers, ESI fuel polishing system and Racor filters are easily visualized, as are the Cruisair air conditioning compressors. The Reverso oil change system is located on the port side of the machinery space, just below the generator. A large container on the aft starboard side houses the Glendinning shore power cable retraction system for the two 75' cables.

Lazarette: Accessed down a short ladder via the cockpit hatch, the well-lit lazarette provides convenient storage space for spares, tools, fenders and cleaning supplies, fishing gear, luggage and whatever else you can think of. The steering assembly is easily visualized, as is the hydraulic heat exchanger to port. The engine room may be accessed through the lazarette.

Foredeck/Portuguese Bridge: The foredeck on the Krogen 55' Expedition is raked high off the water making for a dry, comfortable ride. The twin anchor pulpit safely holds the Super Max and Delta anchors that are powered by a Maxwell VWC 3500 hydraulic windlass. Each anchor has 300' of marked 1/2" chain rode. The Delta anchor is monitored with a digital chain counter at the helm station. Chain locker access is through the painted Freeman hatch on deck. Two shore power, cable TV and dock water connections are installed on the starboard foredeck; fresh and salt-water wash down inlets are found to port. The Portuguese bridge provides access to the port and starboard wing stations. From these stations, the engines can be started and stopped, the boat steered, and the bow thruster engaged. The wing stations are covered with custom green canvas. Two large custom cushions on top of each large bow locker to port and starboard complete the beauty and utility of the foredeck. One can easily embark and debark the vessel from access points on the bow and Portuguese bridge to either port or starboard. These alternate access points are invaluable when only fixed docks are available in marinas. A portable, four-step Todd resin ladder resides on the bow to make this process even more convenient.

Boat Deck: Proceeding on either side of the Portuguese bridge leads you to the large boat deck. The boat deck houses the Steelhead 1250 crane (with remote control) for launching and retrieving the tender that is mounted on two custom chocks with one bow and two stern tie downs. The tender is a seven passenger, 2015 center console 13' AB Oceanus VST with a newly painted (October 2018) fiberglass bottom. The tender is powered by a recently serviced (2018) 60 hp Yamaha engine and has been actively used. When not in use, the tender is covered in green Sunbrella. With the tender launched, the boat deck provides a large outdoor space for sunbathing and/or entertaining. There is a bank of cabinets behind the pilothouse bulkhead. A large barbecue grill and a Fusion stereo with two speakers enhance entertaining. The grill (covered in custom green canvas) sits atop a cabinet providing storage for cooking utensils and cleaning supplies. A covered sink with hot and cold water adjacent to the grill makes for easy cleanup. Two propane tanks reside in a neighboring cabinet. A complete set of extra lines and other equipment are conveniently and easily stored in another large cabinet. A sliding hatch provides access to the steps leading to the cockpit below. Two aft starboard side rails were refitted (2017) for easy removal to facilitate deploying/retrieving the tender.

Kadey-Krogen 55 Olympia

Construction details from builder:

- Hull and superstructure molds from high-grade female tooling.
- Hull construction includes use of USA-made, Cook[®] gel coat. Hand-laid Knytex[®] fiberglass construction with closed-cell PVC sandwich core used in topsides. Solid fiberglass below waterline with blister-resistant vinylester resin utilized on first two laminates below the waterline, with Aramid fiber/FRP reinforcements.
- Superstructure includes end-grain balsa core and Knytex[®] surface mats for print-through reduction.
- Teak aft deck. Boat and fore decks have GripTex[®] non-skid finish. Bulwark has molded plank lines with gel coat finish.
- Polyurethane formulated marine sealants used at hull-to-deck, boat deck joints and exterior fittings.
- Marine-grade plywood bulkheads with molded fiberglass hat section stringers.
- Interior finished with handcrafted solid cherry and veneers.

Olympia has been lovingly maintained and thoughtfully upgraded. Service records for all major equipment are dutifully logged and available for you to review onboard during your visit*.

Exclusions: Owners personal items, rugs, model hulls, artwork and tools.

Highlighted Equipment Aboard ***Olympia***:

Galley:

- Blue Star four burner propane stove/oven
- Two door Jenn Air refrigerator/freezer with icemaker
- Large stainless steel sink
- GE Profile microwave/convection oven
- GE Profile dishwasher
- GE Monogram 57-bottle wine refrigerator
- Granite countertops
- Grohe faucet with sprayer
- Rolling trash and recycle containers
- Custom spice rack and bookshelf
- Rolling cabinet drawers
- Glass tile backsplash behind stove
- Elongated granite countertop to form breakfast bar
- Lighted curio cabinet with glass shelf

Kadey-Krogen 55 Olympia

Navigation/Electronics:

- Two Garmin chart plotters embedded with GPSMAP 7215 series software, including BlueChart g2 Vision charts, with sonar, weather and radar capabilities. New electronic charts purchased October 2018
- Two MMSI-registered, DSC equipped Garmin VHF 100/200 series radios – one in pilothouse, one in saloon. Both interfaced with NMEA 2000 network
- Fusion MS-UD/AV755 radio (new in 2017) in pilothouse, linked to units in galley/saloon, cockpit and boat deck
- Garmin satellite weather receiver and antenna
- Garmin autopilot with wireless remote control
- Rogue WAVE Wi-Fi wireless module with repeater
- GS25 antenna with built in rate compass. 10 Hz position update rate

Portuguese bridge:

- Forward of pilothouse, secure passageway
- Port and starboard wing stations with controls for bow thruster and engines
- Sunbrella covers for wing station controls
- Four integrated storage lockers
- Pilothouse windows covered in custom green Textilene fabric

Entertainment Components:

- KVH M5 satellite dome for TV reception
- Blu-Ray disc player
- 4-zone Fusion radio with 8 speakers installed in pilothouse, saloon, cockpit and boat deck
- Samsung 46" flat screen Smart TV

Other key components:

- Bosch clothes washer and clothes dryer
- Two custom leather club chairs
- TV lift system port side
- Full ship, four-zoned air conditioning and heating (total 36,000 BTUs)
- ESI fuel polishing system
- 16 kW Northern Lights generator with Sound Shield
- Reverso oil change system plumbed to engines, generator and transmissions
- ABT hydraulics package including active fin stabilization, Maxwell windlass and 22 hp bow thruster
- Forward and aft shore power inlets (4 in all)
- WEMA freshwater tank monitor
- Black and gray water tank monitors

Kadey-Krogen 55 Olympia

- Magnum inverter/charger with monitor
- Rudder angle indicator at helm station
- Two Llebroc multi-positioning helm chairs covered in Ultraleather
- Maxwell digital chain counter
- LED lighting throughout including navigation lights and outside lighting
- 150 lb. Super Max 22 Rigid anchor with 300' 1/2" marked chain
- 50 lb. Delta anchor with 300' 1/2" chain (chain counter at helm station)
- Kahlenberg horn with auto and manual settings
- Three transom-mounted, removable staples
- Two stainless steel pop-up swim platform cleats
- Under mounted swim platform ladder
- Portuguese bridge-mounted category 1 EPIRB
- AB Oceanus VST 13' 7-person tender with center console, fiberglass bottom and 60 hp Yamaha engine
- Custom green Sunbrella tender cover
- Custom green canvas wing station covers
- Custom Sunbrella covered, striped bow cushions
- Custom green canvas grill cover
- Custom green canvas fender covers
- Custom green Textilene pilothouse window covers
- Bow tow eye
- Anchor snubber
- Engine room Seafire fire suppression system
- Engine room and boat deck cameras
- Spares for engines and other equipment
- Two Charles isolation transformers
- Sea Star propane barbecue grill mounted on boat deck cabinet
- Four offshore adult lifejackets and eight coastal adult lifejackets
- 1 SOLAS, Coast Guard approved flare kit
- Fusion four-zone stereo audio system with eight speakers throughout boat (inside and outside)
- Satellite weather on both chart plotters
- Salt and fresh water washdown spigots on bow; fresh water washdown spigot in cockpit
- Dual Glendinning cable master system in cockpit
- PTO on generator for hydraulic bow thruster
- Two sets of 3/4" custom colored dock lines
- Three large fenders, two large ball fenders

Kadey-Krogen 55 Olympia

LAYOUT:

Main Level - Cabins, Saloon, Cockpit:

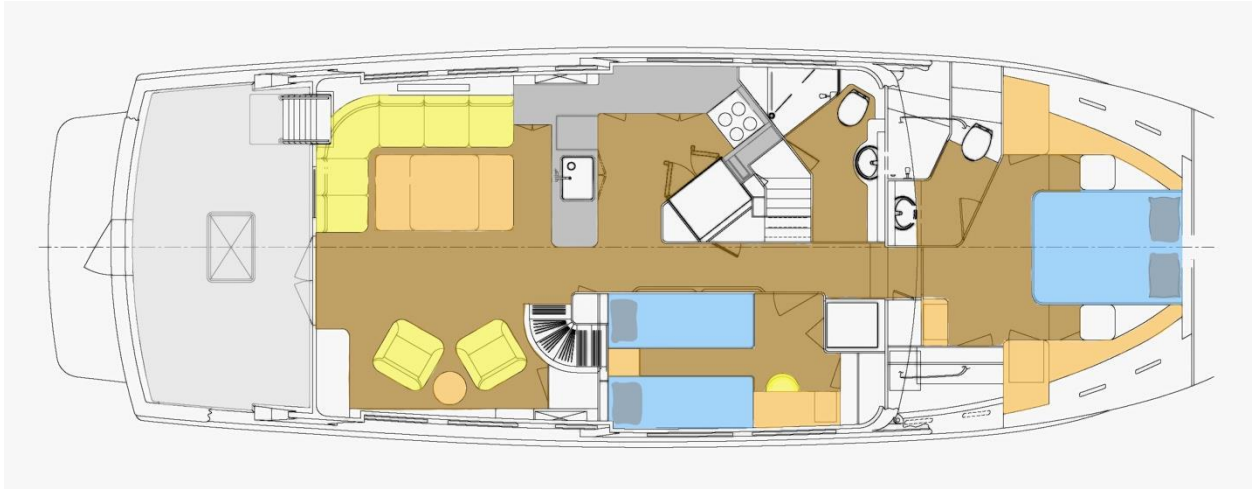

Pilothouse:

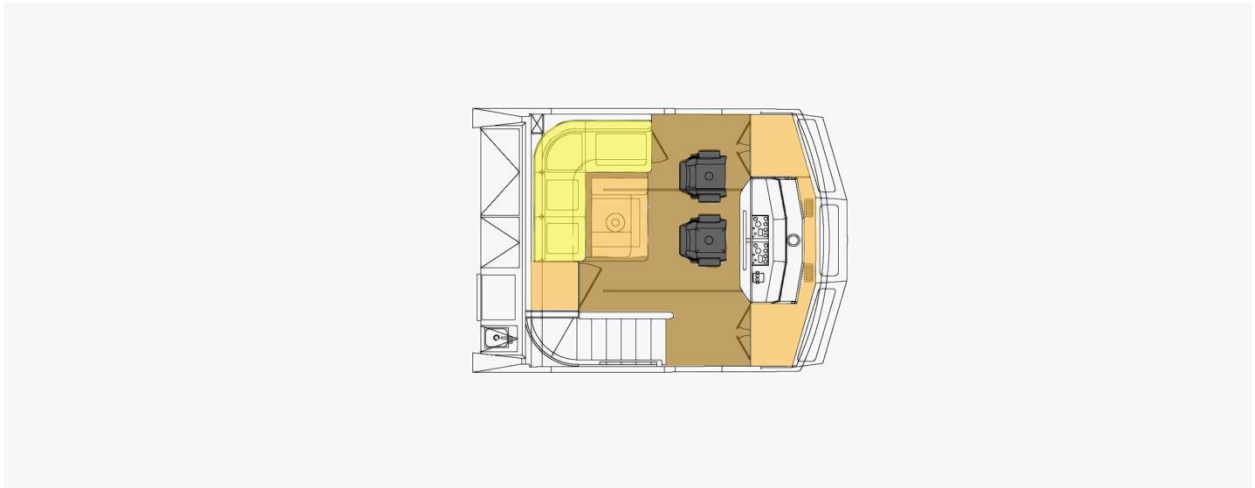

Kadey-Krogen 55 Olympia

SPECIFICATIONS:

YACHT NAME:	<i>Olympia</i>
BRAND AND MODEL:	Kadey-Krogen 55 Expedition
TYPE:	Long range passage maker with raised pilothouse
LOCATION:	Stuart, FL
MODEL YEAR:	2014
HULL NUMBER:	5
HULL COLOR:	White gelcoat with Awlgrip Forest Green bow and boot stripes
REGISTRY:	United States Coast Guard documented
DESIGNER:	Jim Krogen
BUILDER:	Asia Harbor Yacht Builders Co., Ltd.
HULL MATERIAL:	Solid fiberglass
DISPLACEMENT:	90,000 lbs. 40.8 MT
BALLAST:	6,900 lbs. 3.13 MT (Lead)
RANGE:	4,300 miles @ 7 knots; 2,800 miles @ 8 knots
SPEED:	Cruise 8.5 knots. Top 10.0 knots
LOA:	61' 18.59 M
LWL:	49' 6" 15.08 M
BEAM:	18' 5.48 M
DRAFT:	4' 11.5" 1.52 M
D/L:	323
Cp:	Prismatic Coefficient .64
AIR DRAFT:	23' 8" 7.2M to top of wind instruments
DECK:	White deck with beige nonskid
ENGINE 1 Port:	John Deere 4045 AMF 168 hp (port hours: ~1,914) February 2019
TRANSMISSION	ZF 2.476:1 reduction transmission
PROPELLER / SHAFT	2" Aquamet 22 shafts Four blade propellers 31" x 20" line cutters on both shafts
EXHAUST:	Wet exhaust Centek-Vernalift Muffler
ENGINE 2 Starboard:	John Deere 4045 AMF 168 hp (starboard hours: ~1,910) February 2019
THRUSTER:	ABT TRAC 22 hp hydraulic bow thruster
STABILIZATION:	ABT 220 digital active fins
ELECTRICAL:	60 Hertz – US style – 50 amp
SHORE POWER:	50-amp for house and 50-amp air con, (fore and aft).
GENERATOR:	Northern Lights 16 kW 240V 60Hz (generator hours: ~2,997) February 2019
INVERTER/CHARGER:	Magnum 4000-watt inverter/charger

Kadey-Krogen 55 Olympia

BATTERIES:	Lifeline AGM (installed 2018 and 2019)
INTERIOR LIGHTING:	Imtra LED lighting
WATER MAKER:	Plumbed for water maker but not installed
CLIMATE CONTROL:	Cruisair air conditioning (4) zones (total of 36,000 BTUs)
MACHINERY EQUIPMENT:	Reverso oil changer for mains, transmissions and generator, ESI fuel polishing system
WINDLASS:	Maxwell VWC 3500 hydraulic
GROUND TACKLE:	Super Max 22 Rigid 150 lb. with 300' ½" high-test chain Delta 110 lbs. with 300' 1/2" high test chain
CRANE:	Steelhead SM 1250 – 1,250 pound with remote control
TENDER AND OUTBOARD:	AB Oceanus 13' VST with Yamaha 60 hp engine
NAV/COM BRANDS:	Garmin KVH
ENTERTAINMENT:	Flat screen Samsung 46" Smart TV in saloon on lift Stereo in pilothouse, saloon, cockpit and boat deck
STATEROOMS:	Two: master forward, guest cabin starboard amidships
BEDDING:	Tempur-Pedic mattress in master
HEADS:	Two: Dometic MasterFlush (electric freshwater) in master and guest
SHOWERS:	Two: master and guest
LAUNDRY:	Bosch separate clothes washer and clothes dryer
GALLEY:	Blue Star propane four burner stove with propane oven Jenn Air refrigerator, with freezer drawer and icemaker GE Dishwasher GE microwave/convection oven
INTERIOR WOOD:	Cherry – satin finish
INTERIOR COUNTERS:	Granite counters (many additional surfaces covered)
INTERIOR UPHOLSTERY:	Ultraleather
INTERIOR FLOORING:	Teak and spruce hardwood
BILGE PUMPS:	Electric Rule standard and electric highwater with emergency off engines
TANKAGE: (approx.)	
FUEL:	1,880 gallons 7116.5 L (four aluminum tanks)
HOLDING BLACK:	140 gallons 529.9 L (fiberglass)
HOLDING GRAY:	140 gallons 529.9 L (fiberglass)
FRESH WATER:	500 gallons 1892.7 L (stainless steel)
ADDITIONAL EQUIPMENT:	Intervac central vacuum Two Llebroc helm chairs Two Man Ship ventilation fans in engine room Wireless autopilot remote control Engine room & boat deck cameras
SAFETY:	Engine room SeaFire fire suppression EPIRB (category 1)
PHOTO DATE:	Most detail photos were taken in February, 2019
Note: All information is believed accurate but should be verified.	

Jeff Merrill Yacht Sales, Inc. © 2020 All Rights Reserved www.JMYS.com

Kadey-Krogen 55 Olympia

For additional information please visit Olympia's website, www.kadeykrogen55.com



<https://www.youtube.com/watch?v=vigzmSvyECM&t=16s>

Exclusions: Potential purchasers should assume that items on the vessel at the time of viewing, but not specifically listed on this sheet, are not included with the sale of the yacht. These specifications are

Jeff Merrill Yacht Sales, Inc. © 2020 All Rights Reserved www.JMYS.com

Kadey-Krogen 55 Olympia

believed to be true and correct but cannot be guaranteed. Items excluded include, but are not limited to Paintings, tools, handheld nav gear and binoculars. Owner's personal effects and clothing will be removed prior to closing.

Disclaimer: Jeff Merrill Yacht Sales, Inc. presents the details of this vessel in good faith but cannot guarantee or warrant the accuracy of this information nor guarantee or warrant the condition of the vessel. Buyers should instruct their agents and their surveyors to investigate all details the buyers desire validated. This vessel is offered subject to prior sale, price change, or withdrawal without notice.

Brokerage: JMYS is a US based (licensed and bonded yacht brokerage in California, Florida and Washington) with an international emphasis specializing in ocean capable trawlers. Our brokers are experienced boaters, most are trawler owner/operators with thousands of hours and miles at sea. We treat our clients with respect, we are responsive and not pushy. Our focus is to become your loyal advocate, always looking out for your best interests. The team at JMYS has extensive trawler and motor yacht product knowledge and our skills are available for coaching after the sale has concluded.

Co-Brokerage: Fellow yacht broker association members: This listing is available for co-brokerage and JMYS is a 50/50 house. Courtesy showings are available by appointment. Florida listings subject to appropriate broker licensing required by law.

Kadey-Krogen 55 Olympia

Listing brokers:



Christopher Bruce
+1 603.397.8397
Christopher@JMYS.com

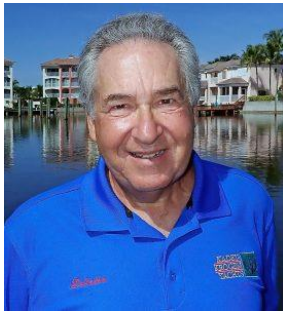

Larry Friedman
+1 317.501.4671
Larry@JMYS.com

